

N=Number of contacts

P.C.B. LAYOUT

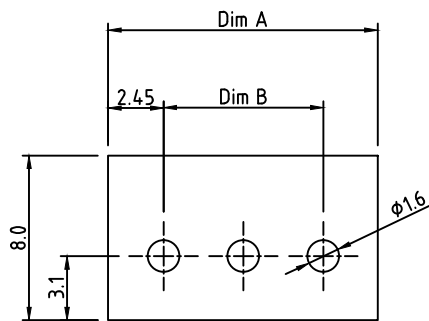

SPECIFICATIONS

Current Rating: 10/10.5 Amps  
 Voltage Rating: 300V  
 Dielectric withstanding: 1.6KV/2.5KV  
 Operating Temperature: -40°C~+115°C  
 Max Processing Temp: 250°C ±10°C /5Sec  
 Contact Material: Copper with Tin Plating  
 Insulator Material: Thermplastic UL 94V-0  
 Safety Approval:

RPLJ- XXABXJ-FG

FG: RoHS Compliant  
 (Lead <4% in Copper Alloy)

02: 2Pos  
 03: 2Pos  
 04: 2Pos  
 "" ""  
 24: 24Pos

J: Black(RAL9005)  
 B: Red(RAL3001/D)  
 C: Orange(RAL2011/P)  
 D: Yellow(RAL1018/A)  
 E: Green(RAL6018/T)  
 F: Blue(RAL5015/A)  
 H: Grey(RAL7035/D)

Dimensions	
A	(N-1)×3.5±4.90
B	(N-1)×3.5

Poles	Tolerance
2P-6P	±0.15
7P-12P	±0.20
13P-18P	±0.25
19P-24P	±0.30

APTOS Technology CONFIDENTIAL  
 This document, and all information it contains, are the confidential, proprietary property of APTOS Technology. Disclosure, duplication or distribution of this document, or any information it contains, in whole or part, without prior written permission from APTOS Technology is strictly prohibited

GENERAL TOLERANCE UNLESS OTHERWISE SPECIFIED	
XXX. ± X	.XX ± 0.10
XX. ± X	.XXX ± X
X. ± 0.50	X' ± 1'
.X ± 0.30	.X' ± 1'

REV. A	DRAWN	10/22/09
DATE 10/22/09	CHECKED	
SCALE 4:1	APPROVED	
UNIT mm		SIZE A4

**AP** APTOS TECHNOLOGY

RPLJ Series  
 3.50mm Terminal Block Header  
 PRODUCT NO. RPLJ- XXABXJ-FG  
 FILE NAME: RPLJ- XXABXJ-FG LF APD.DWG